



property description

Looking for a project? This magnificent, three story, 5 bedroom, end of terrace Victorian house offers a great investment opportunity! 1790 sqft of space, located within a few minutes of Brockley Station (Zone 2 Overground). On the ground floor there is a 26' double reception room with a bay window and high ceilings and a kitchen dining room at the rear, overlooking the garden through another large bay window. There is a side door leading to a lawned private rear garden. The first floor has two large double bedrooms, a huge family bathroom and a separate WC. On the second floor there are two more double bedrooms and a single bedroom. Endwell Road is in the heart of Brockley, only 5 miles away from Central London, there are great local transport facilities such as Brockley Overground Station and good local amenities.

property features

- 5 bedroom end of terrace Victorian house
- Refurbishment investment opportunity
- Private rear garden
- double reception room
- Kitchen breakfast room
- Brockley station within 300m (Overground Zone 2)

ALPS Estates Ltd trading as Pickwick Estates
47 Honor Oak Park Honor Oak
London, SE23 1EA, United Kingdom
Reg No : 7444750
Registered in England

Telephone : 020 3397 1166
Website : <https://www.pickwickestates.co.uk>



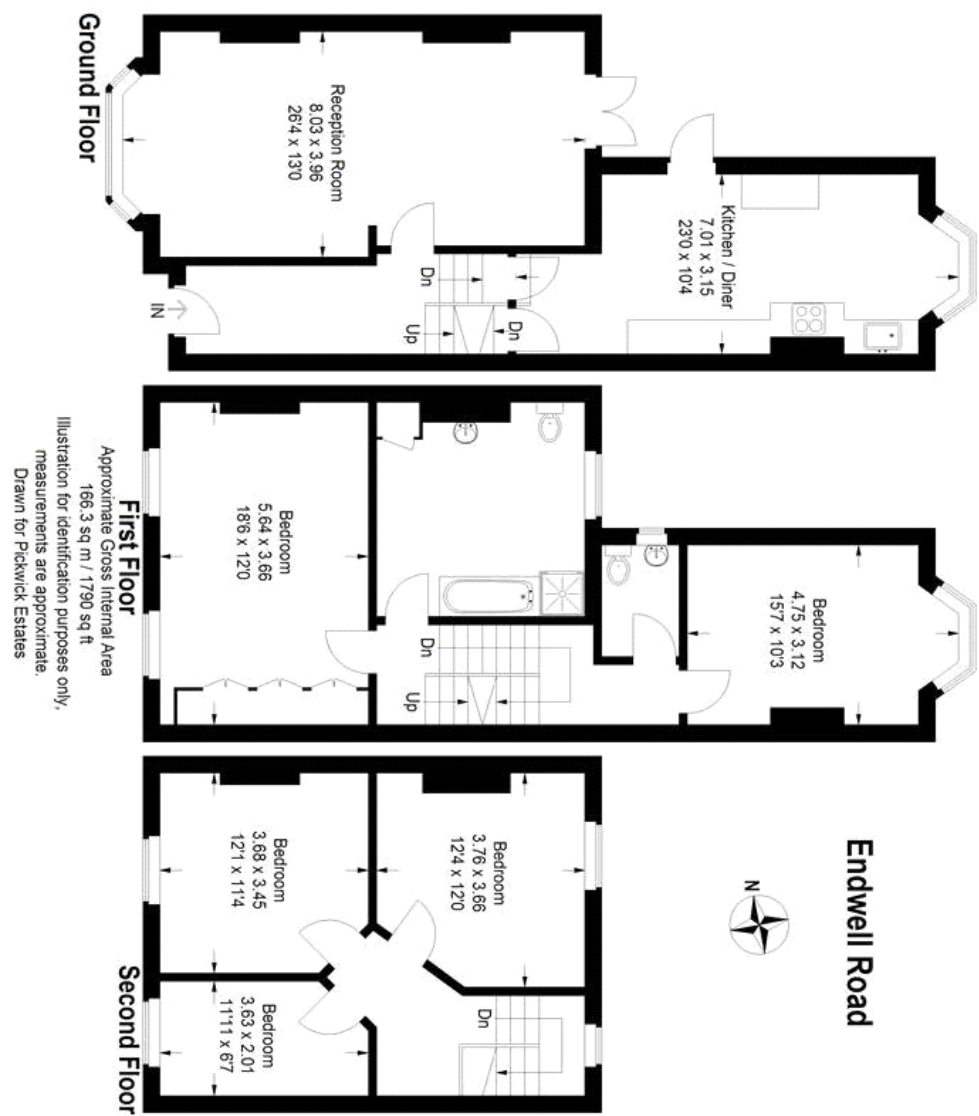

For Full EPC Information, click [here](#)